

GENERAL

Material : Alloy steel
 Safety factor : 4 times
 Standards : DIN 7540
 Finish : Painted
 Temperature range : -40°F up to +392°F, Polar Rated
 Standard certification : Certificate of Conformity
 3.1 material certificate EN 10204

SHACKLES

Spare latches available on request

THIMBLES

SOCKETS

LINKS

SWIVELS

HOOKS

MOORING

OTHERS

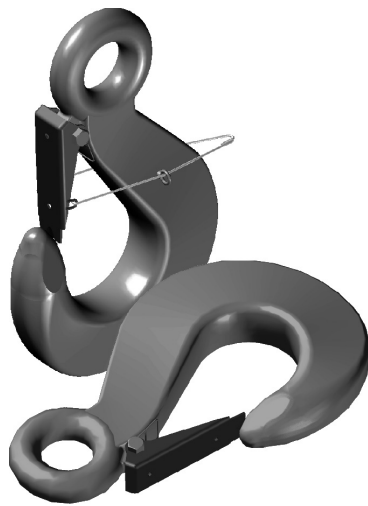

Standard hook with safety latch

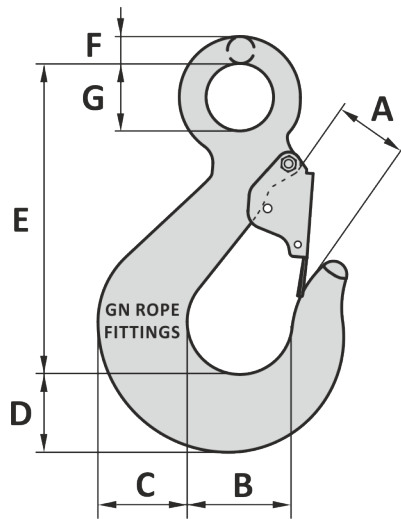

ROV-hook

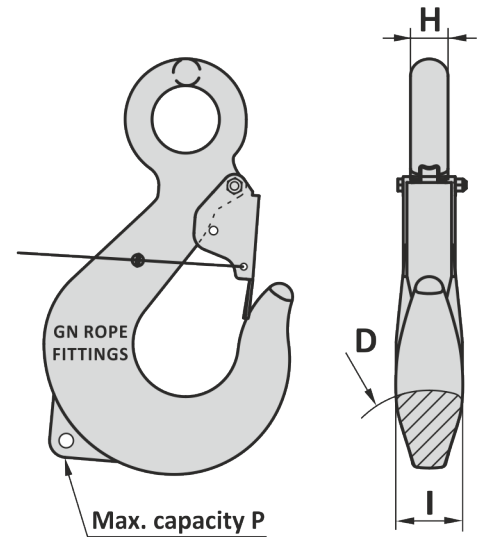

* Standard hooks from WLL 250 ton will supplied with a handling padeye with maximum capacity P, hooks WLL 100 ≤ 200 ton on request

Art. No. standard	Art. No. ROV	WLL ton	MBL ton	A inch	B inch	C inch	D inch	E inch	F inch	G inch	H inch	I inch	P ton	Weight lbs
45001009	45001010	8	32	1 1/32	2 7/16	2 1/8	1 13/16	6 27/32	25/32	1 1/4	25/32	1 1/2		8.2
45001013	45001014	12.5	50	2 1/16	3 3/8	2 11/16	2 9/32	8 5/8	1	1 9/16	1	1 7/8		17
45001017	45001018	16	64	2 5/16	3 15/32	2 15/16	2 9/16	9 11/16	1 3/32	1 13/16	1 3/32	2 3/32		22
45001021	45001022	20	80	2 1/2	3 29/32	3 11/32	2 7/8	10 29/32	1 1/4	2 1/16	1 1/4	2 13/32		29
45001029	45001030	28	112	2 13/16	4 13/32	3 25/32	3 1/4	12 1/16	1 13/32	2 3/8	1 13/32	2 15/32		37
45001032	45001033	31	125	3 3/32	4 15/16	4 3/16	3 3/8	13 3/4	1 1/16	2 19/32	1 9/16	2 3/4		51
45001041	45001042	40	160	3 9/16	5 1/2	4 21/32	4 1/16	15 9/32	1 25/32	2 27/32	1 25/32	3 1/32		75
45001051	45001051	50	200	4 1/16	6 7/32	5 5/16	4 9/16	17 13/32	2	3 5/16	2	3 1/2		108
45001064	45001065	63	250	4 1/2	6 15/16	5 15/16	5 1/8	19 7/16	2 3/16	3 9/16	2 3/16	3 29/32		139
45001081	45001082	80	320	5 5/32	7 13/16	6 5/8	5 23/32	24	2 15/32	4	2 15/32	4 9/16		218
45001101	45001102	100	400	5 15/16	8 7/8	7 11/16	6 25/32	25 19/32	2 29/32	4 9/16	2 29/32	4 15/16		353
51000150	51000151	150	600	6 13/16	9 27/32	8 7/8	7 27/32	30 1/8	3 3/8	5 5/8	3 3/8	6 5/16		573
51000200	51000201	200	800	7 7/8	10 13/16	10 1/4	9 9/16	33 15/32	4	5 29/32	4	7 3/32		919
51000250	51000251	250	1000	9 3/16	12 3/16	11 13/32	10 19/32	36 1/32	4 23/32	6 11/16	4 23/32	7 7/8	9.5	1270
51000300	51000301	300	1200	10 3/8	13 25/32	13	12 3/16	41 19/32	5 1/2	7 15/32	5 1/2	8 29/32	12	1808
51000400	51000401	400	1600	11 15/16	15 3/4	14 31/32	13 9/16	47 1/16	6 1/16	8 3/4	6 1/16	9 1/16	17	2480
51000500	51000501	500	2000	14 1/16	17 23/32	16 1/8	15 11/32	53 9/16	7 7/8	8 15/32	7 7/8	12 19/32	17	4057

Tolerance: Forged parts ± 5%, machined parts ± 1/32 inch

13-09-2019

Material : Alloy steel
 Safety factor : 4 times
 Standards : DIN 7540
 Finish : Painted
 Temperature range : -40°C up to +200°C, Polar Rated
 Standard certification : Certificate of Conformity
 3.1 material certificate EN 10204

Spare latches available on request

Standard hook with safety latch

ROV-hook

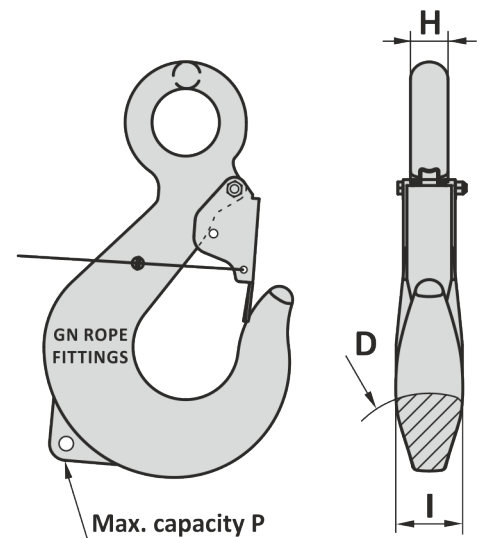
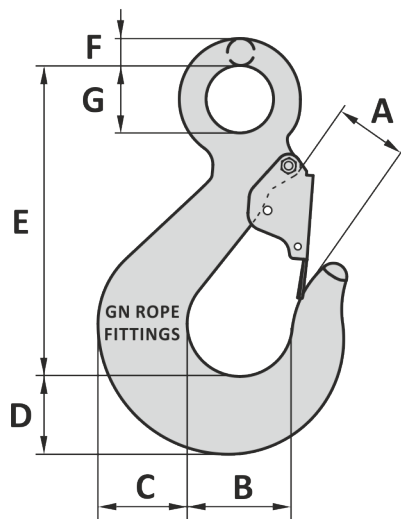
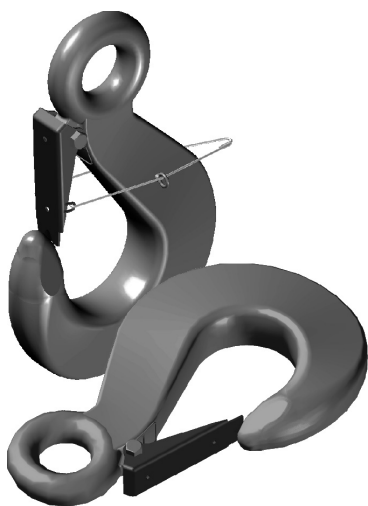

* Standard hooks from WLL 250 ton will be supplied with a handling padeye with maximum capacity P, hooks WLL 100 ≤ 200 ton on request

Art. No. standard	Art. No. ROV	WLL ton	MBL ton	A mm	B mm	C mm	D mm	E mm	F mm	G mm	H mm	I mm	P ton	Weight kg
45001009	45001010	8	32	39	62	54	46	174	20	32	20	38		2.6
45001013	45001014	12.5	50	52	79	68	58	219	25	40	25	48		5.7
45001017	45001018	16	64	59	88	75	65	246	28	46	28	53		8.0
45001021	45001022	20	80	64	99	85	73	277	32	52	32	61		12
45001029	45001030	28	112	71	112	96	83	313	36	60	36	63		16
45001032	45001033	31	125	80	125	106	92	349	40	66	40	70		22
45001041	45001042	40	160	90	140	118	103	388	45	72	45	80		32
45001051	45001051	50	200	103	158	135	116	442	51	84	51	89		46
45001064	45001065	63	250	114	176	151	130	494	56	90	56	99		63
45001081	45001082	80	320	131	198	168	145	610	63	102	63	110		80
45001101	45001102	100	400	151	225	195	172	650	74	116	74	125		160
51000150	51000151	150	600	173	250	225	199	765	86	130	86	160		260
51000200	51000201	200	800	200	275	260	237	850	102	150	102	180		417
51000250	51000251	250	1000	233	310	290	269	928	120	170	120	200	9.5	576
51000300	51000301	300	1200	264	350	330	310	1052	140	190	140	220	12	820
51000400	51000401	400	1600	303	400	380	344	1195	170	210	170	240	17	1125
51000500	51000501	500	2000	370	450	410	390	1360	200	215	200	320	17	1840

Tolerance: Forged parts ± 5%, machined parts ± 1 mm

13-09-2019