

Material : Cast steel  
 Safety factor : 4 times  
 Finish : Galvanized  
 Temperature range : -20°C up to +200°C  
 Standard certification : Certificate of Conformity

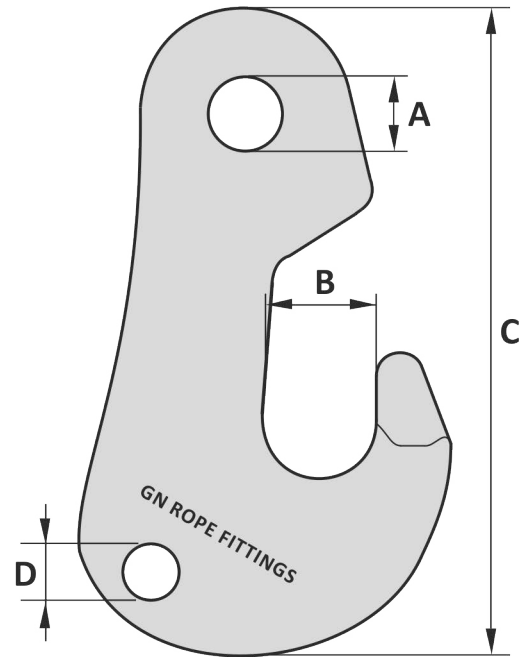
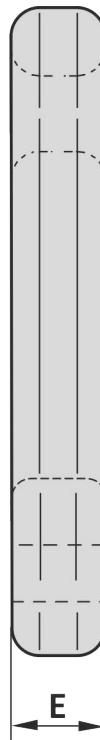
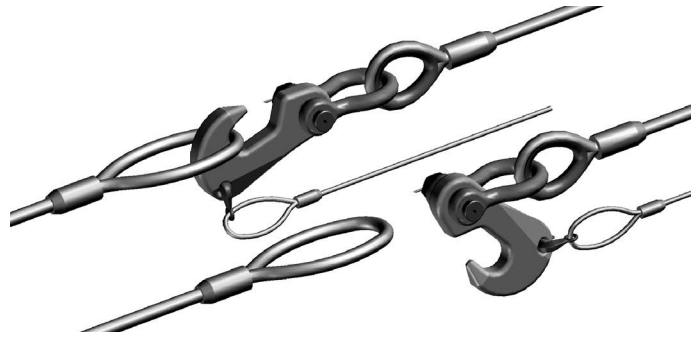

| Art. No. | WLL<br>ton | MBL<br>ton | A<br>mm | B<br>mm | C<br>mm | D<br>mm | E<br>mm | Weight<br>kg |
|----------|------------|------------|---------|---------|---------|---------|---------|--------------|
| 74000015 | 15         | 60         | 38      | 58      | 343     | 32      | 45      | 11           |
| 74000020 | 20         | 80         | 40      | 74      | 343     | 32      | 60      | 14           |
| 74000025 | 25         | 100        | 52      | 86      | 440     | 38      | 65      | 26           |
| 74000050 | 50         | 200        | 80      | 112     | 618     | 45      | 90      | 67           |
| 74000080 | 80         | 320        | 90      | 130     | 709     | 62      | 110     | 116          |

Tolerance: ± 5%

| Art. No. | WLL<br>ton | MBL<br>ton | A<br>inch | B<br>inch | C<br>inch | D<br>inch | E<br>inch | Weight<br>lbs |
|----------|------------|------------|-----------|-----------|-----------|-----------|-----------|---------------|
| 74000015 | 15         | 60         | 1 1/2     | 2 3/32    | 13 1/2    | 1 1/4     | 1 25/32   | 24            |
| 74000020 | 20         | 80         | 1 5/16    | 2 29/32   | 13 1/2    | 1 1/4     | 2 3/8     | 31            |
| 74000025 | 25         | 100        | 2 1/16    | 3 3/8     | 17 5/16   | 1 1/2     | 2 5/16    | 57            |
| 74000050 | 50         | 200        | 3 5/32    | 4 13/32   | 24 5/16   | 1 25/32   | 3 3/16    | 148           |
| 74000080 | 80         | 320        | 3 5/16    | 5 1/8     | 27 29/32  | 2 7/16    | 4 5/16    | 256           |

Tolerance: ± 5%

01-07-2011

GENERAL  
 SHACKLES  
 THIMBLES  
 SOCKETS  
 LINKS  
 SWIVELS  
 HOOKS  
 MOORING  
 OTHERS