

GENERAL

Material : Forged high tensile steel quenched and tempered
 Safety factor : 6 times
 Standards : Generally according to US Federal Spec RR-C-271
 Finish : Galvanized
 Temperature range : -4°F up to +392°F
 Standard certification : Certificate of Conformity
 3.1 material certificate EN 10204

SHACKLES

THIMBLES

SOCKETS

LINKS

SWIVELS

HOOKS

MOORING

OTHERS



BOW TYPE SAFETY PIN

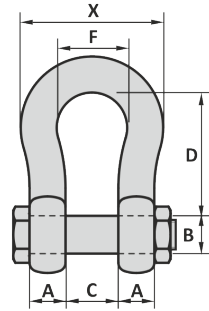

BOW TYPE SCREW PIN

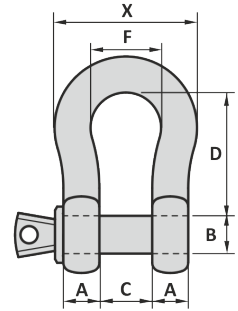

DEE TYPE SAFETY PIN

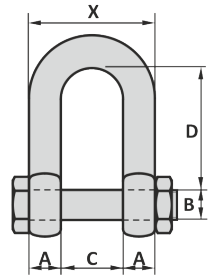

DEE TYPE SCREW PIN

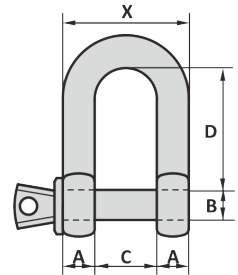

Art. No. Dee screw pin	Art. No. Dee safety pin	Art. No. Bow screw pin	Art. No. Bow safety pin	WLL ton	A inch	B inch	C inch	D inch	D inch	E inch	F inch	X inch	X inch	Y inch	Y inch	Packing pcs	Weight lbs
								Dee	Bow			Dee	Bow	Dee	Bow		
32000003		37000004		0.33	3/16	1/4	3/8	3/4	7/8	1 1/32	5/8	2 5/32	1 1/2	1 1/16	1 13/32	25	0.04
32000005		37000006	37000009	0.5	1/2	5/16	1 1/32	7/8	1 1/8	1 1/16	2 5/32	1 1/2	1 1 1/32	1 2 1/32	1 1 1/16	25	0.13
32000007		37000007	37000008	0.75	1 1/32	3/8	1/16	1 1/2	1 1/4	2 5/32	7/8	1 1/4	1 1/16	1 3 1/32	2 3/16	25	0.24
32000010		37000011	37000017	1	3/8	7/16	1/16	1 1/4	1 7/16	2 9/32	1 1/32	1 1/16	1 1 1/16	2 5/16	2 1/2	25	0.35
32000015		37000015	37000016	1.5	7/16	1/2	3/4	1 7/16	1 1 1/16	1 1/16	1 1/8	1 1/8	2	2 1 1/16	2 2 9/32	25	0.49
32000021	32000025	37000020	37000029	2	1/2	5/8	7/8	1 1 1/16	2	1 1 1/2	1 1/4	1 3 1/32	2 9/32	3 3/16	3 1/2	25	0.93
32000030	32000039	37000030	37000039	3.25	5/8	3/4	1 1/16	2	2 1/2	1 1/16	1 1/16	2 3/16	2 1 5/16	3 3 1/16	4 3/16	20	1.6
32000040	32000049	37000040	37000049	4.75	3/4	7/8	1 1/32	2 3/16	3	1 1 1/16	2	2 2 3/32	3 1/2	4 1 3/32	5 1/16	10	2.6
32000060	32000069	37000060	37000069	6.5	7/8	1	1 1 3/32	2 7/8	3 3/4	2 1/16	2 5/32	3 3/32	4	5 5/32	5 1 1/16	5	4.0
32000080	32000089	37000080	37000089	8.5	1	1 1/32	1 1 1/16	3 1 1/32	3 3/4	2 7/16	2 1 1/16	3 2 1/32	4 2 1/32	6 1/16	6 7/16	5	5.7
32000090	32000099	37000090	37000099	9.5	1 3/32	1 1/4	1 2 1/32	3 3/16	4 1/4	2 1 1/32	2 1 1/16	4 1/16	5 5/32	6 3/16	7 7/32	4	8.2
32000120	32000129	37000120	37000129	12	1 1/4	1 3/8	2	3 1 1/16	4 1 1/32	2 2 1/32	3 1/4	4 1 1/32	5 2 5/32	7 7/32	7 2 9/32	3	11
32000130	32000139	37000130	37000139	13.5	1 3/8	1 1/2	2 1/4	4 1 1/32	5 1/4	3 5/32	3 5/8	5	6 3/8	8 7/32	8 1 1/16	14	14
32000170	32000179	37000170	37000179	17	1 1/2	1 2 1/32	2 3/8	5	5 3/4	3 1 1/32	3 2 1/32	5 1 1/32	6 7/8	9 1/16	9 1 1/16	18	18
32000250	32000259	37000250	37000259	25	1 2 5/32	1 3 1/32	2 2 1/32	5 3/8	7	4 1/16	4 3 1/32	6 1/16	8 1/2	10 1 1/16	11 1 1/16	31	31
32000350	32000359	37000350	37000359	35	1 3 1/32	2 1/4	3 1/4	6 3/4	7 3/4	4 3/8	5 1/16	7 3/16	9 3/8	12	13 1 1/2	44	44
32000420	32000429	37000420	37000429	42.5	2 1/4	2 9/16	3 3/4	7 1 1/32	8 3/4	5 1/8	6 1/16	8 7/32	10 2 5/32	13 1 1/32	14 2 1/32	62	62
32000550	32000559	37000550	37000559	55	2 9/16	2 3/4	4 1/8	8	10 1/4	5 2 1/32	7 5/32	9 1/4	12 3/16	14 1 1/16	17 1/16	88	88
	32000859		37000859	85	2 1 1/16	3 1/4	5	9	12 1 1/16	6 3/8	7 1 1/32	10 2 1/32	13 3/8	16 1 1/16	20 3/4	137	137

Tolerance: Inside length ± 7.5%, all other forged parts ± 5%, machined parts ± 1/32 inch

04-02-2016

Material : Forged high tensile steel quenched and tempered
 Safety factor : 6 times
 Standards : Generally according to US Federal Spec RR-C-271
 Finish : Galvanized
 Temperature range : -20°C up to +200°C
 Standard certification : Certificate of Conformity
 3.1 material certificate EN 10204



BOW TYPE SAFETY PIN

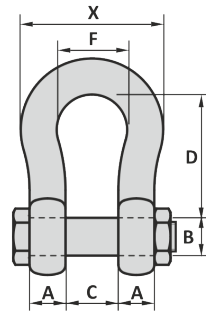

BOW TYPE SCREW PIN

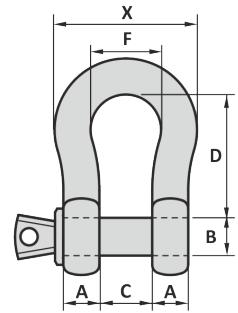

DEE TYPE SAFETY PIN

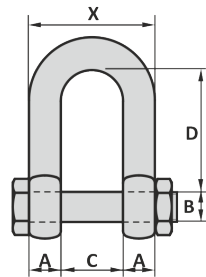

DEE TYPE SCREW PIN

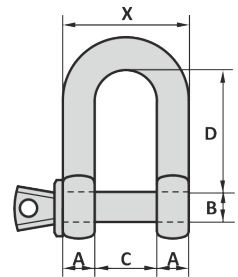

Art. No. Dee screw pin	Art. No. Dee safety pin	Art. No. Bow screw pin	Art. No. Bow safety pin	WLL ton	A mm	B mm	C mm	D mm	D mm	E mm	F mm	X mm	X mm	Y mm	Y mm	Packing pcs	Weight kg
								Dee	Bow			Dee	Bow	Dee	Bow		
32000003		37000004		0.33	5	6	10	19	22	12	16	20	26	33	36	25	0.02
32000005		37000006	37000009	0.5	7	8	12	22	29	17	20	26	34	42	49	25	0.06
32000007		37000007	37000008	0.75	9	10	14	26	32	20	22	32	40	50	56	25	0.11
32000010		37000011	37000017	1	10	11	17	32	37	23	26	37	46	59	64	25	0.16
32000015		37000015	37000016	1.5	11	13	19	37	43	27	29	41	51	68	74	25	0.22
32000021	32000025	37000020	37000029	2	14	16	22	43	51	34	32	50	58	81	89	25	0.42
32000030	32000039	37000030	37000039	3.25	16	19	27	51	64	40	43	59	75	97	110	20	0.74
32000040	32000049	37000040	37000049	4.75	19	22	31	59	76	46	51	69	89	112	129	10	1.2
32000060	32000069	37000060	37000069	6.5	22	25	36	73	83	52	58	80	102	134	144	5	1.8
32000080	32000089	37000080	37000089	8.5	25	28	43	85	95	59	68	93	118	154	164	5	2.6
32000090	32000099	37000090	37000099	9.5	28	32	47	90	108	66	75	103	131	167	185	4	3.7
32000120	32000129	37000120	37000129	12	32	35	51	94	115	72	83	115	147	180	201	3	4.9
32000130	32000139	37000130	37000139	13.5	35	38	57	115	133	80	92	127	162	209	227		6.5
32000170	32000179	37000170	37000179	17	38	42	60	127	146	88	99	136	175	230	249		8.2
32000250	32000259	37000250	37000259	25	45	50	74	149	178	103	126	164	216	271	300		14
32000350	32000359	37000350	37000359	35	50	57	83	171	197	111	138	183	238	305	331		20
32000420	32000429	37000420	37000429	42.5	57	65	95	190	222	130	160	209	274	345	377		28
32000550	32000559	37000550	37000559	55	65	70	105	203	260	145	180	235	310	376	433		40
	32000859		37000859	85	75	83	127	229	329	162	190	277	340	427	527		62

Tolerance: Inside length ± 7.5%, all other forged parts ± 5%, machined parts ± 1 mm

04-02-2016